

MULTI-PORT MANIFOLDS

Manifold block

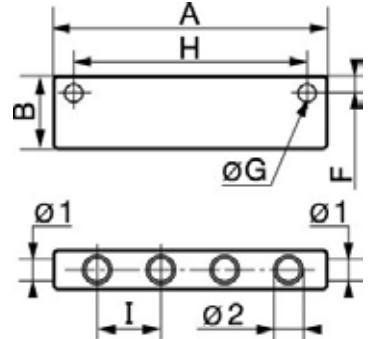

Min/max operating pressure

0 / 218 psi

| Part number | Female thread | Net weight (Kg) | Dim. A (inch) | Dim. B (inch) |
|--------------|----------------|-----------------|---------------|---------------|
| A16 3814S2 | G3/8; G1/4 | 0,12 | 2.83 | 1.18 |
| A16 3814S3 | G3/8; G1/4 | 0,174 | 4.25 | 1.18 |
| A16 3814S4 | G3/8; G1/4 | 0,232 | 5.67 | 1.18 |
| A16 3814S5 | G3/8; G1/4 | 0,29 | 7.09 | 1.18 |
| A16 3814S6 | G3/8; G1/4 | 0,35 | 8.5 | 1.18 |
| A16 203201S4 | NPT1/2; NPT1/4 | 0,44 | 6.1 | 1.57 |
| A16 203201S5 | NPT1/2; NPT1/4 | 0.5 | 7.48 | 1.57 |